

CyberPower



FTTx SYSTEMS
OUTDOOR

CyberShield

12Vdc – 48Vdc Outdoor FTTx Backup Power Solutions

Features

- Outdoor design
- Universal input voltage
- Microprocessor intelligent control
- Telemetry interface
- Easy user-replaceable batteries
- Cold start function
- Optional extendable runtime
- Silenceable audible-alarm for signaling utility power failure and low battery

The CyberPower CyberShield outdoor battery backup series provides cable telephone, wireless local loop (WLL) and fiber to the premise (FTTP) providers with a dependable and cost effective local power supply for customer premise equipment (CPE) during power outages. The CyberShield outdoor family provides Multiple Service Operators with a local powering solution that has lower installation costs, lower operational costs and higher quality than competing power technologies.

Designed for outdoor installation, CyberShield outdoor products allow service providers easy access to the power supply and battery. Outdoor mounting eliminates the need to schedule a service appointment with a subscriber to enter a residence or business location. CyberShield outdoor battery backup products supply continuous 12Vdc or 48Vdc (depending on model) to local power network interface devices (NIDs), cable telephone modems, wireless base stations and fiber to the home Optical Network Terminals (ONTs) or integrated access devices.



MODEL	CS24C12V2-E
AC INPUT	
Input Voltage Range	90 – 264Vac
Input Frequency Range	47 – 70Hz
Input Power Cord	US / CANADA
Output Ground Reference	Floating Ground
DC OUTPUT	
Output Voltage	12Vdc
Continuous Power Capability	24W
Output Power Max	24W
Efficiency (at Full Load)	> 75%
Output Connection	7-Pin Communication Signal Connector (DECA ME030-350-07)
BATTERY	
Battery Type	Sealed, Maintenance Free Lead-Acid Battery
Numbers of Battery	7.2Ah / 12V x 1
Typical Recharge Time	< 24 Hours
Replaceable	Yes
SURGE PROTECTION	
Mode	Yes
WARNING DIAGNOSTICS	
LED Indicators	AC (Battery Mode Indicator), Output (On/Off Indicator), Battery (Missing/Replacement Indicator)
MANAGEMENT	
Auto-Charge	Yes
Communication Interface	On Battery, Replace Battery, Battery Missing, Low Battery
PHYSICAL	
Maximum Dimensions (L*W*D)	204mm x 275mm x 99mm
Weight (kg)	3.5 (with battery)
ENVIRONMENT	
Operating Temperature	5°F – 122°F (-15°C – 50°C)
Operating Humidity	0 – 95% Non-condensing within Enclosure
Max Operating Elevation	10,000 ft. (3,000 m)
Max Storage Elevation	50,000 ft. (15,000 m)
Storage Temperature	5°F – 122°F (-15°C – 50°C)
COMPLIANCE	
System	UL60950-1/CSA CS22.2 NO.60950-1-03, IEC/EN 60950-1, FCC PART 15 Class B, CISPR 22 Class B, NEMA Type 3R

1.877.297.6937

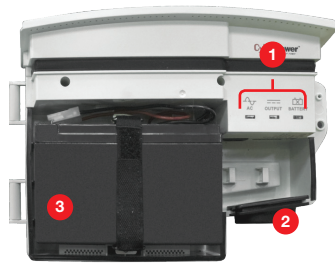

CS24C12V2-E

1. LED Status Indicators
2. Environmentally Sealed Strain Relief
3. User Replaceable Battery

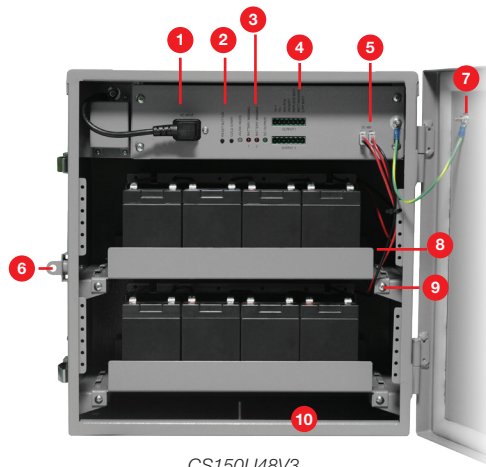

CS150U48V3

1. Internal AC Powering Wiring Inlet
2. Alarm Silence & Cold Start
3. LED Indicators
4. Output Receptacles
5. Battery Wiring Harness Plug-In
6. Door Padlock
7. Bonding Point to Ground Door
8. Battery Tray
9. Battery Tray Mounting Screw
10. Customer Ground Stud
11. Aluminum Enclosure

MODEL	CS150U48V3		
AC INPUT			
Input Voltage Range	90 – 264Vac		
Input Frequency Range	47 – 70Hz		
Power Factor	> 0.9 at Rating Voltage and Max Load		
Output Ground Reference	Floating Ground		
DC OUTPUT			
Output Voltage	48Vdc		
Continuous Power Capability	150W		
Output Power Max	150W		
Efficiency (at Full Load)	> 85% at Rating Voltage and Max Load		
Output Connection	7-Pin Communication Signal Connector (DECA-ME230-50014) x 2		
BATTERY			
Battery Type	Sealed, Maintenance Free Lead-Acid Battery		
Numbers of Battery	7.2AH / 12V (x 4 or x 8)		
Typical Recharge Time	< 24 Hours		
Replaceable	Yes		
SURGE PROTECTION			
Mode	Yes (6kV @ 8/20μs) per IEEE C62.41.2 and GR-1089		
WARNING DIAGNOSTICS			
Audible Indicators	On Battery, Low Battery		
LED Indicators	AC (Battery Mode Indicator), Output (On/Off Indicator), Battery (Missing/Replacement Indicator)		
MANAGEMENT			
Auto-Charge	Yes		
Communication Interface	On Battery, Replace Battery, Missing, Low Battery		
PHYSICAL			
Maximum Dimensions (L*W*D)	400mm x 389mm x 230mm		
Weight (kg)	28 (with 8pcs batteries)		
ENVIRONMENT			
Operating Temperature	-4°F – 114.8°F (-20°C – 46°C) + Solar Loading (see Note (1) (2) (3) (4))		
Operating Humidity	0 – 95% Non-condensing within Enclosure		
Max Operating Elevation	10,000 ft. (3,000 m)		
Max Storage Elevation	50,000 ft. (15,000 m)		
Storage Temperature	-4°F – 131°F (-20°C – 55°C)		
COMPLIANCE			
System	UL60950-1/CSA CS22.2 NO.60950-1-03, IEC/EN 60950-1, FCC PART 15 Class B, CISPR 22 Class B, NEMA Type 3R		
COMPLIANCE			
Model Number	CS150U48V3	CS150U48V3-SB	CS150U48V3-GC
Remark	Standard 7.2AH/12V batteries included	No battery included	Gel cell 7.2AH/12V batteries included for extended temperature range application

Note (1): Electronics operational from -40°C to 46°C plus solar loading with no de-rating, operation from 55°C to 65°C with linear de-rating, i.e. 75% of max output at 65°C (149°F).

Note (2): Operation from -40°C to 46°C plus solar loading without battery heater and decreased reserve time availability (when operated below 25°C).

Note (3): Battery heater recommended for extended use in ambient less than -20°C when not able to be installed in a controlled environment.

Note (4): Gel battery use recommended for extended use in ambient greater than 40°C when not able to be installed in a controlled environment.



CPSWW.COM